

MEWP Familiarization: SE Series

1930SE^{AC}
2632SE^{AC}
3346SE^{AC}
4046SE^{AC}
4555SE^{AC}

SE^{AC} Series Familiarization

(ANSI A92.22 6.2.5)

- 6.2.5.1 Prior to user's authorization of an operator to use a specific model of MEWP, the user must ensure the operator is familiarized on the following, and as specified by the manufacturer.
- Do not operate your MEWP until you have read and understood the Manufacturer's Operator Manual, have performed the workplace inspection, pre-start inspection, routine maintenance, and have completed all the test operations detailed in the operating instructions section of your manual.
- **Manual location is in manual enclosure on the inside of the front guardrail.**
- **Confirm that the required manual(s) as specified by the manufacturer are with the MEC Micro 19.**



Lower Controls

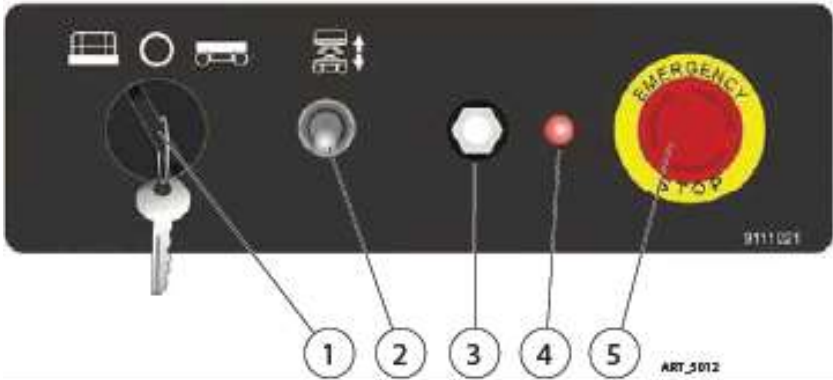

Control		Description	
1	Key Switch	PLATFORM	Select to operate from the platform control panel.
		BASE	Select to operate from the base control panel
		OFF	Select to stop operation from either control panel
2	Platform Lift/Lower Switch	With the Key Switch in the BASE position, move this switch up to lift the platform or down to lower the platform.	
3	Outdoor/Indoor Switch	OUTDOORS	Select to limit the maximum height when outdoors.
		INDOORS	Select to allow unrestricted height when indoors.
4	Platform Overload	Indicates too much weight on the platform. Remove weight from the platform to restore function and continue.	
5	Emergency Stop Switch	Press the EMERGENCY STOP switch at any time to stop all machine functions. Turn switch clockwise to reset.	
6	7-Amp Circuit Breaker	Trips when there is excess electrical load. Push to reset.	

Platform Controls

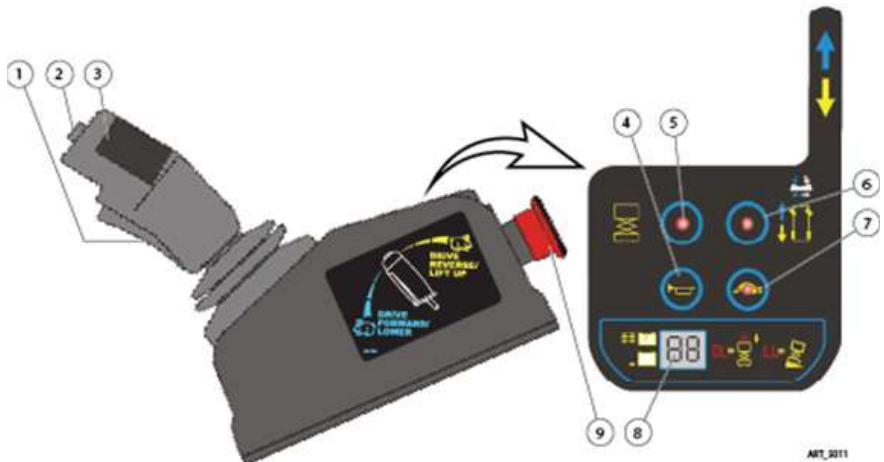

Control		Description
1	Function Enable Switch	Squeeze to enable DRIVE, STEER, and LIFT functions from the Control Handle.
2	Steer Switch	Using your thumb, press and hold the rocker switch to steer Left or Right.
3	Control Handle	DRIVE LIFT Proportionally controls Forward and Reverse travel. Proportionally controls Lift and Lower Functions
4	Horn Button	Press to sound warning horn.
5	Lift Select	Press this button to enable the Lift function. <ul style="list-style-type: none"> Regardless of if the Function Enable Switch is pressed or released, if no machine movement is made in 10 seconds then the current selection of Lift will time-out. Release then press the Function Enable Switch to reactivate selected function.
6	Drive Select	Press this button to enable the Drive function. <ul style="list-style-type: none"> Regardless of if the Function Enable Switch is pressed or released, if no machine movement is made in 10 seconds then the current selection of Drive will time-out. Release then press the Function Enable Switch to reactivate selected function.
7	Drive Speed Select	Light ON indicates Low Speed Drive is selected. Light OFF indicates High Speed Drive is selected.
8	LED Display	Indicates the state of battery charge and displays diagnostic codes when necessary.
9	Emergency Stop Switch	Press the EMERGENCY STOP switch at any time to stop all machine functions. Turn switch clockwise to reset.

Additional Emergency Controls, Features & Limitations

2632SE – 4555SE

1930SE



Feature	1930SE ^{AC}	2632SE ^{AC}	3346SE ^{AC}	4046SE ^{AC}	4555SE ^{AC}
Max. Platform Height	19 ft.	26 ft.	33 ft.	40 ft.	45 ft.
Max. Platform Capacity	500 lbs.	500 lbs.	750 lbs.	550 lbs.	500 lbs.
Deck Extension Capacity	250 lbs.	250 lbs.	250 lbs.	250 lbs.	250 lbs.
Deck Extension Persons	1 per.	1 per.	1 per.	1 per.	1 per.
Max. Wind Speed	28 mph	28 mph	28 mph	28 mph	28 mph

- **ELECTROCUTION HAZARD! THIS MACHINE IS NOT INSULATED!**
- See operator's manual for additional information and instructions for safe use.

Operating Characteristics

Features:

- Direct electric drive for longer duty cycle
- Sheet Material Tray
- 36" rollout deck extension
- Charger and power to platform connect to single outlet on chassis

Options:

- 900W Inverter
- Tool Tray
- Proactive Platform Safety System® (PPSS) senses overhead obstructions
- Leak Containment System® (LCS)

*See operator's manual for specific options and feature characteristics.

For More Information

Contact your local Dealer, Rental Provider or MEC Aerial Work Platforms.

MEC Aerial Work Platforms

- +1 (877) 632-5438
- +1 (559) 842-1500
- info@MECawp.com

MEC Parts

- +1 (559) 842-1523
- parts@MECawp.com

MEC Product Support

- +1 (559) 842-1537
- service@MECawp.com

MEC Address & Website

- 1401 S Madera Ave,
Kerman, Ca 93630
- www.MECawp.com

This information is provided as product familiarization as called for by ANSI A92.22. and CSA B 354. It is not intended to take the place of information provided by the MEC Operators manual or instruction provided by your equipment supplier. Further, all operators are to be trained before operating this equipment. Please contact MEC Aerial Work Platforms if you require additional information.

